

70-K-54(25) - SPEEDLINE System Data Sheet - Version V1 (24-10-23)

SPEEDLINE 70mm 'C' Stud Partition @600mm Ctrs,
with Knauf 15mm Soundshield Plus each side,
25mm APR

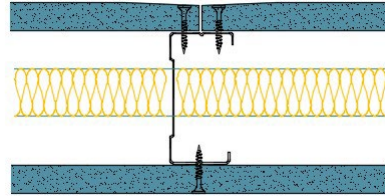

System Performance Breakdown

Fire Resistance:

BS476 Part 22:1987:

Test Ref & Date or Applied Ref & Report:

Max Height:

Thickness:

Duty Grade: BS 5234: Part 2:1992:

Sound Insulation:

60/60 Minutes (Integrity/Insulation).

BRE 285458 - BRE Report P102396-1011B

Refer to Speedline Specification Clause

102 mm. (At Base Track, Excluding Finishes)

Severe - Annexes A-F

47 R_w dB, Date Tested or Assessed Against - 70-K-53(25)

Test Code:
H17426AA
Test Date:
27/06/2011

Freq. Hz	R dB
50	20.7
63	13.8
80	10.1
100	20.1
125	26.0
160	31.3
200	35.8
250	40.0
315	43.6
400	46.8
500	50.6
630	54.9
800	58.3
1 000	61.3
1 250	62.4
1 600	63.8
2 000	61.6
2 500	47.8
3 150	40.8
4 000	44.4
5 000	47.1
6 300	
8 000	
10 000	

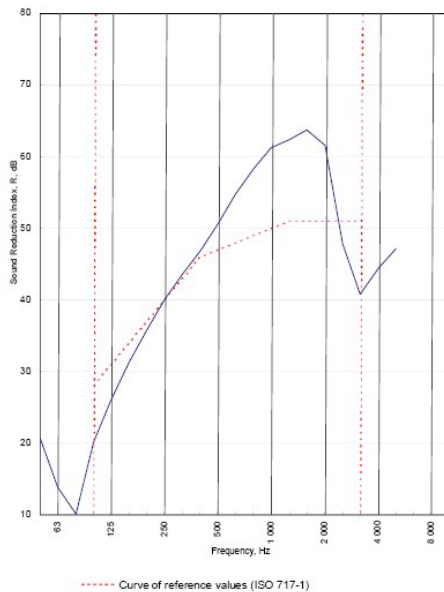

Rating according to BS EN ISO 717-1:1997	R_w (C;Ctr) = 47 (-3;-9) dB		
Evaluation based on laboratory measurement results obtained by an engineering method:	$C_{50-3150}$ = -7 dB	$C_{50-5000}$ = -6 dB	$C_{100-5000}$ = -3 dB
	$C_{9,50-3150}$ = -18 dB	$C_{9,50-5000}$ = -18 dB	$C_{9,100-5000}$ = -9 dB

TESTED AT ONE OF THE UKAS ACCREDITED LABORATORIES BELOW

B.T.C
(H-Ref on Graph)

B.R.E

AIRO

S.R.L

Customer: Metsec plc Hepsec Division

BTC 17426A: Page 9 of 11



SPEEDLINE Drywall Systems, Adsetts House, 16 Europa View, Sheffield Business Park, Sheffield, S9 1XH.

Tel: 0114 231 8030.

Email: enquiries@speedlinedrywall.co.uk

(As per the requirements set out in ISO/IEC 17025:2017 regarding test data the results stated have been carried out by voestalpine Metsec plc as part of the contract to supply Speedline Metal Sections to SIG Plc)